

# Dometic

## SPARE PARTS LIST

REFRIGERATOR FOR TRAILER INSTALLATION

### MB52c

Product No. 926 09 15/18/19/20/21/22/28

Item No.	Part No.	Description	Item No.	Part No.	Description
1	17 24 60-08/1	Door, complete without door panel	32	17 27 01-00/5	.. Insulation
2	16 84 75-00/2	. Door gasket	33	200 28 00-00/7	.. Outer part of shutter
3	16 90 09-00/8	. Door pan (order item 21 at the same time)	34	17 27 00-00/7	.. Inner part of shutter
4	16 69 46-00/4	. Door for butter compartment, complete	35	17 26 99-00/1	... Gasket
5	16 69 45-00/6	.. Door	36	200 28 21-00/3	.. Spring
6	16 38 53-00/5	.. Spring	37	16 84 80-00/2	Drip tray
7	16 38 54-00/3	.. Hinge pin	38	200 28 11-00/4	Shelf, upper
8	29 12 85-00/5	. Door shelf, upper	39	667 13-00/9	Washer
9	17 12 07-00/4	. Reinforcing strip, vertical	40	16 84 62-00/0	Front plate
10	16 89 29-00/8	. Bottle holder	41	16 83 87-00/9	Lining
11	16 89 40-00/5	. Fastening strip, outer	42	200 28 10-00/6	Shelf, lower
12	16 89 39-00/7	. Fastening strip, inner	43	729 52 77-51/6	Screw, LKXS B6x8
13	16 13 81-00/9	. Screw, spec. B6x10	44	729 53 40-01/7	Screw, RXS B8x10
14	16 58 07-00/9	. Door shelf, lower	45	17 29 72-00/2	Hinge plate, lower
15	16 13 80-00/1	. Screw, spec. B6x10, stainless	46	16 84 66-00/1	Cabinet support bar, left-hand
16	17 12 05-00/8	. Reinforcing strip, horizontal	47	16 81 17-01/8	Lock pin with chain
17	200 09 98-00/1	. Nameplate (Dometic)	48	15 26 88-00/8	Catch spring
18	729 72 23-03/9	. Screw, KFXS B4x8 fn.	49	16 84 65-00/3	Cabinet support bar, right-hand
19	17 24 57-00/4	. Door frame, upper	50	17 01 45-00/7	Friction washer
20	729 52 77-51/6	. Screw, LKXS B6x8	51	17 07 96-00/7	Bearing bush
21	200 08 88-00/4	. Instruction label	52	734 11 53-01/8	Washer, BRB 6.4x12
22	17 24 19-00/4	. Door frame, bottom	53	735 11 60-01/0	Washer, FBB 7.1
23	200 28 72-00/6	Door panel, beige, for 926 09 15	54	200 05 44-00/3	Hinge bolt
	200 28 72-01/4	Door panel, brown, for 926 09 18	55	724 13 27-01/9	Screw, RX 5x12
	200 28 72-02/2	Door panel, turquoise, for 926 09 19	56	17 24 55-04/0	Shutter, complete
	200 28 72-03/0	Door panel, avocado, for 926 09 20	57	729 52 75-01/5	. Screw, RXS B6x6
	200 21 03-01/4	Door panel, stainless, for 926 09 21	58	17 10 20-00/1	. Handle
24	17 28 37-00/7	Hinge plate, upper, left-hand	59	200 28 33-00/8	. Holder link
25	27 43 63-00/1	Expansion rivet	60	200 28 32-00/0	Blow out protection
26	17 27 10-01/4	Freezer compartment, complete	61	200 28 39-00/5	Front support bar
27	200 28 05-00/6	. Front with shutter, complete	62	729 52 75-01/5	Screw, RXS B6x6
28	729 52 79-40/5	.. Screw, RXS B6x10, stainless	63	17 20 98-00/6	Trim strip
29	200 28 03-00/1	.. Hinge flange	64	17 28 36-00/9	Hinge plate, upper, right-hand
30	200 28 02-00/3	.. Front	65	200 28 75-00/9	Spirit level
31	200 28 20-00/5	.. Shaft	66	27 28 59-00/0	Ice tray, complete
			67	15 73 03-00/9	. Ice divider
			68	27 30 62-00/0	. Ice tray
			69	200 28 14-00/8	Bottom shield
			70	200 02 08-00/5	Shelf, middle, gated

May 1968

Publication No.  
3263/Service

When ordering spare parts always state:

MODEL · QUANTITY · PART NUMBER · DESCRIPTION · VOLTAGE

820 46 51

Distr. enl. SFS 509/1961 p. 2



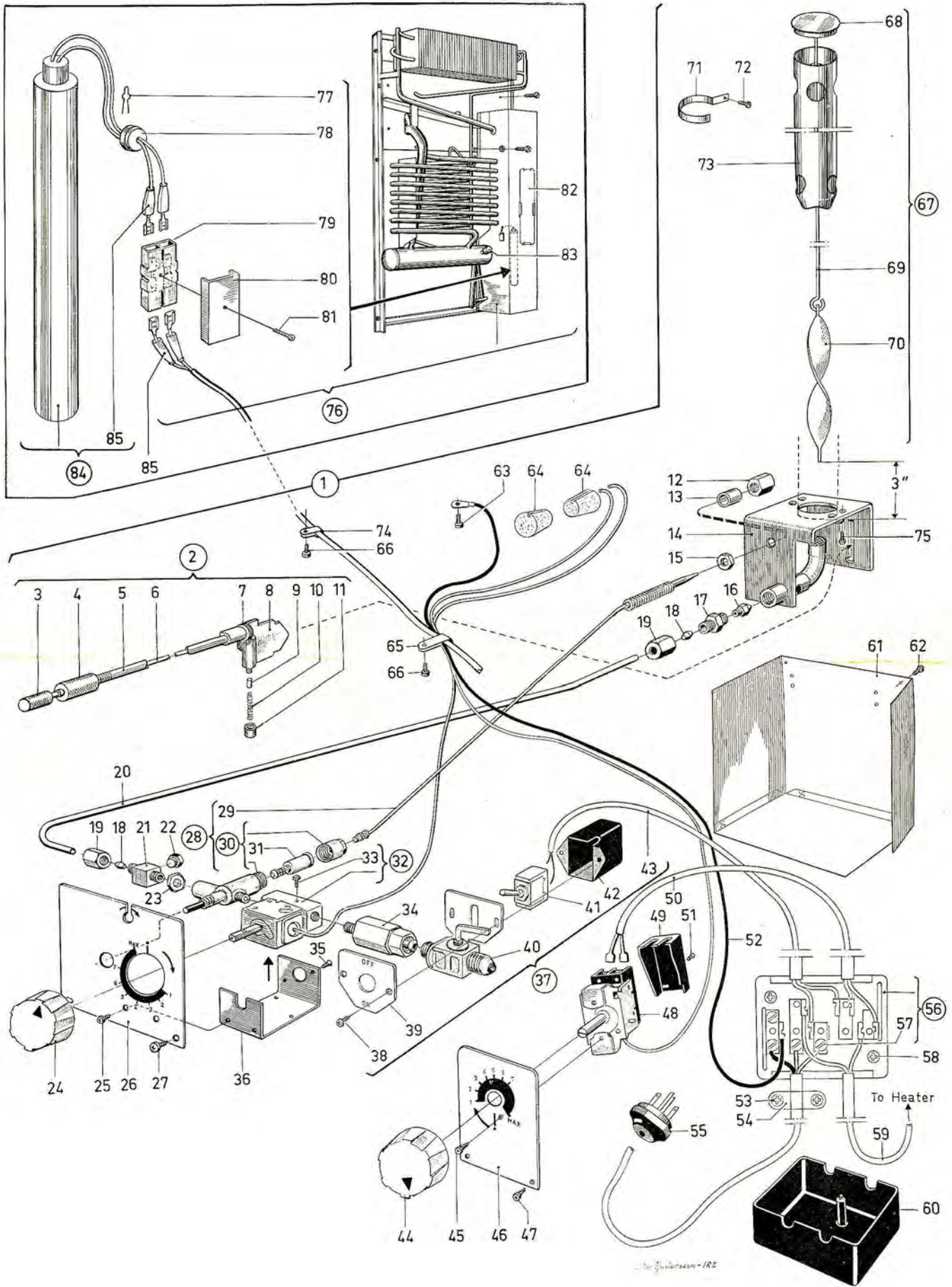



Item No.	Part No.	Description	Item No.	Part No.	Description
1	17 33 59-00/1	Equipment 52 EB4, compl.	44	17 26 91-00/8	. Thermostat knob
2	17 07 86-00/8	. Spark lighter, compl.	45	14 93 91-01/3	. Screw, RX no. 6 BAx3/16"
3	17 07 85-00/0	.. Turning knob	46	200 09 45-00/2	. Thermostat bracket with scale
4	27 01 31-00/6	.. Locking sleeve	47	729 53 36-01/5	. Screw, RXS B8x6
5	17 07 82-00/7	.. Guide tube	48	17 28 21-01/9	. Electric thermostat Ranco A 52
6	17 07 83-00/5	.. Shaft	49	17 28 22-00/9	. Contact cover
7	27 01 30-00/8	.. Knurled wheel	50	17 31 41-00/3	. Cable compl. for thermostat
8	27 05 17-00/6	.. Support	51	729 52 21-01/9	. Screw, RXS B4x6
9	27 01 27-00/4	.. Flint for lighter	52	17 29 70-00/6	. Earth wire, compl.
10	27 01 37-00/3	.. Spring	53	729 52 83-01/9	. Screw, RXS B6x16
11	17 07 81-00/9	.. Spring holder	54	56 10 14-01/0	. Saddle clip
12	17 08 27-00/0	. Union nut M8x1	55	17 10 34-00/2	. Electric plug
13	17 33 44-00/3	. Spacer sleeve 10 mm	56	58 15 57-70/9	. Terminal block
14	17 32 21-00/3	. Burner, compl.	57	723 22 50-10/5	.. Screw, KCS 3.5x5
15	16 93 86-00/0	. Nut, M8x1	58	729 52 75-01/5	. Screw, RXS B6x6
16	17 33 45-11/7	. Burner jet 52 for propane operation	59	17 29 71-00/4	. Cable for heater, compl.
	17 33 45-09/1	. Burner jet 43 for butane operation	60	58 15 65-71/2	. Cover with screw
17	17 32 22-00/1	. Connection piece	61	16 76 96-00/4	. Gas burner cover
18	17 32 13-00/0	. Olive	62	729 52 75-01/5	. Screw, RXS B6x6
19	17 32 15-00/5	. Union nut	63	724 12 85-01/9	. Screw, RX 4x6
20	17 33 64-00/1	. Gas inlet pipe	64	15 02 45-00/9	. Plug
21	17 32 14-00/8	. Connection piece	65	29 18 90-00/2	. Cable clip
22	16 93 80-00/3	. Plug screw	66	729 52 79-01/7	. Screw, RXS B6x10
23	17 33 66-00/6	. Lock nut	67	17 29 76-00/3	. Baffle, compl.
24	17 26 91-00/8	. Thermostat knob	68	17 29 74-00/8	.. Flue cap
25	729 52 75-01/5	. Screw, RXS B6x6	69	17 29 75-00/5	.. Support wire for baffle
26	17 27 94-02/6	. Thermostat bracket with scale	70	15 48 39-00/5	.. Baffle
27	729 53 36-01/5	. Screw, RXS B8x6	71	16 86 97-00/1	. Flue support
28	17 07 91-00/8	. Safety valve, compl.	72	14 89 78-00/0	. Screw, RX 1/4"x5/8"
29	16 93 72-00/0	.. Thermo-couple element TE12D3Z	73	17 20 73-00/9	. Flue only
30	17 07 55-00/3	.. Safety valve STG 1/6-S4	74	27 10 20-00/0	. Cable clip
31	200 09 99-00/9	... Safety valve magnet	75	14 89 78-00/0	. Screw, RX 1/4"x5/8"
32	17 27 92-00/4	. Gas thermostat, Ranco V 35			
33	17 28 19-01/3	.. By-pass screw, Ranco S22	76	928 51 02-00/1	Cooling unit 510A1 compl.
34	17 28 10-00/4	. Gas filter with nipple and nut	77	17 06 92-00/8	. Lock spring
35	14 96 00-00/9	. Screw	78	17 06 91-00/0	. Bushing
36	17 27 93-02/8	. Angle bracket	79	240 02 97-00/4	. Connection block
37	17 31 14-00/0	. Cut-off valve, with switch and cable	80	17 34 55-00/7	. Cover
38	729 52 77-01/1	.. Screw, RXS B6x8	81	729 52 83-01/9	. Screw, RXS B6x16
39	17 16 27-01/1	.. Sign	82	17 34 30-00/0	. Cover
40	17 31 00-00/9	.. Cut-off valve, with holder	83	17 32 28-00/8	. Filling cap
41	17 21 68-00/7	.. Switch	84	17 06 79-01/3	Heater 110V
42	17 31 01-00/7	.. Protection cover	85	240 02 98-00/2	. Protection sleeve
43	17 32 27-00/0	.. Cable for switch, compl.			

EAST-MIDWEST  
INSTAMATIC CORPORATION  
530 McDonald Street,  
Elkhart, Indiana

WEST COAST  
WARD & SON, INC.,  
P.O. Box 3505  
City of Industry, Calif. 91744

CANADA  
GREG LUND PRODUCTS LIMITED  
521 North Service Road, P.O. Box 220,  
Oakville, Ontario



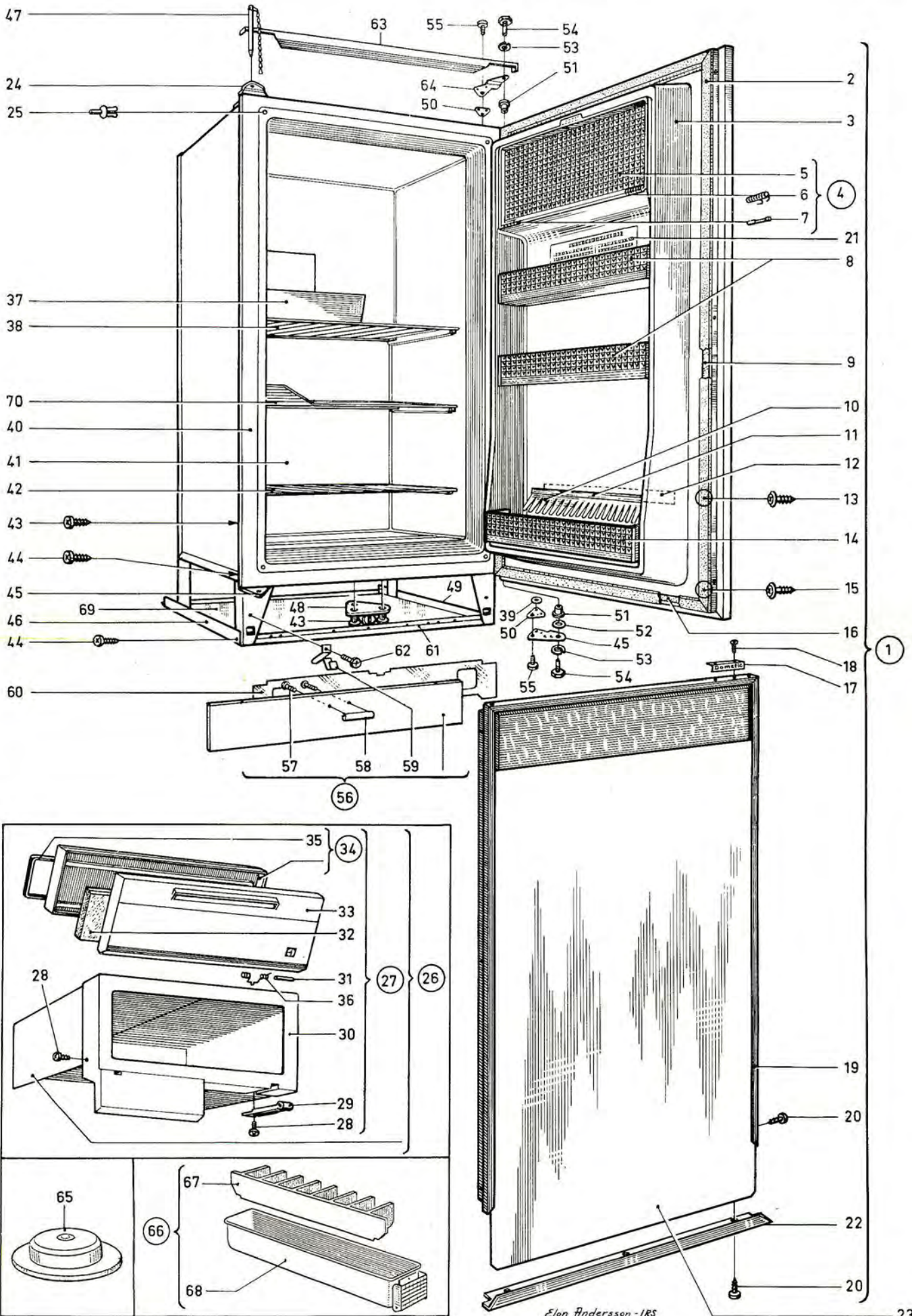

Elon Andersson - IRS